



ENGINEERING LTD

NUMBER ONE FOR PLANT HIRE
OPERATED AND SELF DRIVE HIRE

Date: 4th November 2009

URGENT SAFETY BRIEF

Rexquote Genie Z60 – High and Low speed Settings

As previously briefed, the new Genie Z60 AccessRailers are now fitted with a High Speed Travel Interlock, which will only allow the MEWP to work at crawling speed.

The faster, travel speed will only be available to you when all the following has taken place:

Booms fully lowered

Boom telescoped fully in

Basket swivelled fully to left side, fully to right side or at mid swivel position.

Basket lowered on Jib boom so that platform floor is below 1.4 m above rail level

Boom slewed to 0 ° or 180 ° and Slew lock pin lowered into locking plate.

Slew lock Pin LED illuminated on Basket control panel.

Drive speed select switch in Level position.

The Slew lock pin is vitally important and must be right down to get the higher travelling speed as shown below:

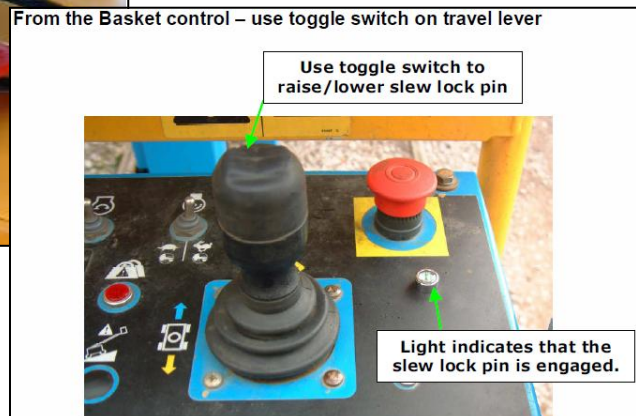

A laminated guide explaining this is available in the toolbox of every machine fitted with the modification.

Andy Young
SHEQ Director